

BORON CARBIDE NOZZLES CATALOGUE



ATM INTERNATIONAL



ATM

BORON CARBIDE NOZZLES

Boron carbide nozzle offer the longest life with optimum air a brasive use. Boron carbide is ideal for aggressive a brasive such as aluminum oxide and selected mineral aggregates when rough handling can be avoided. Boron carbide will typically outwear tungsten carbide by five to ten times and silicon carbide by three to five times. Boron carbide nozzles are recommended for use with a brasive such as aluminum oxide and aggressive aggregates.

LONG VENTURI NOZZLES



Long venture style nozzles yield about a 40% greater production rate than straight boron nozzles. The internally tapered design of the venture nozzle accelerates and evenly distributes the a brasive over the entire blast pattern. These nozzles are designed for use with a 1-1/4" I.D. blast for maximum cutting on hard-to-clean surface.

ATM-VSA/B Series boron carbide Long venture nozzles

This nozzle is designed for job where the nozzle is generally 8 or more inches away from the surface being blasted. For high production jobs-expect longer nozzle life. Aluminum or nylon jacket and threads.

ADD: No.38 XueYuan Nanlu, Haidian District, Beijing, 100082, P.R.China
Tel: (86-10) 62224902; Fax: (86-10)-62224902
Email:like@atmcn.com
<http://www.atmbj.com>



ATM

Thread Style: ATM-VSA Series 1-1/4, 1 1/2 N.P.S.M.

ATM-VSB Series 2, 4-1/2 U.N.C.

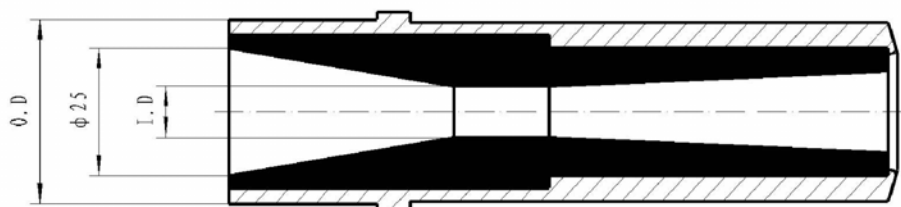
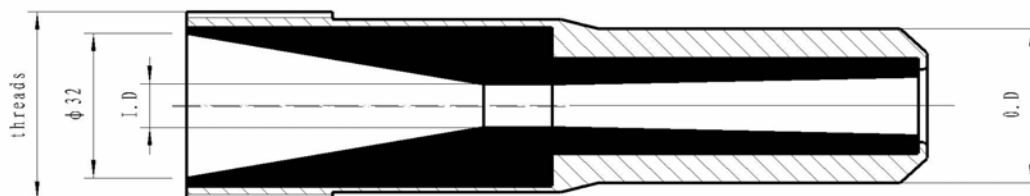

MODEL NO.	I.D.	O.D.	LENGTH
ATM-VSA/B-45	1/4" (6.4mm)	1-5/8" (36mm)	125mm
ATM-VSA/B-50	5/16" (7.9mm)	1-5/8" (36mm)	145mm
ATM-VSA/B-55	3/8" (9.5mm)	1-5/8" (36mm)	165mm
ATM-VSA/B-60	7/17" (11.1mm)	1-5/8" (36mm)	195mm
ATM-VSA/B-65	1/2" (12.7mm)	1-5/8" (36mm)	220mm

ADD: No.38 XueYuan Nanlu, Haidian District, Beijing, 100082, P.R.China
Tel: (86-10) 62224902; Fax: (86-10)-62224902
Email: like@atmcn.com
<http://www.atmbj.com>



ATM

DOUBLE VENTURI NOZZLES



The double venture offers a 35% larger blast pattern than a standard long venture with only a very slight loss in a brasive velocity. Designed to be used on jobs where medium cutting action is required with a more even dispersion of a brasive throughout the larger blast pattern. Excellent for plastic or agricultural a brasives.

ATM-DVA/B Series boron carbide double venture nozzles

Boron carbide liner with aluminum jacket and threads or middle flange

Thread Style: ATM-VSA Series 1-1/4, 1-1/2 N.P.S.M.

ATM-VSB Series 2, 4-1/2 U.N.C.

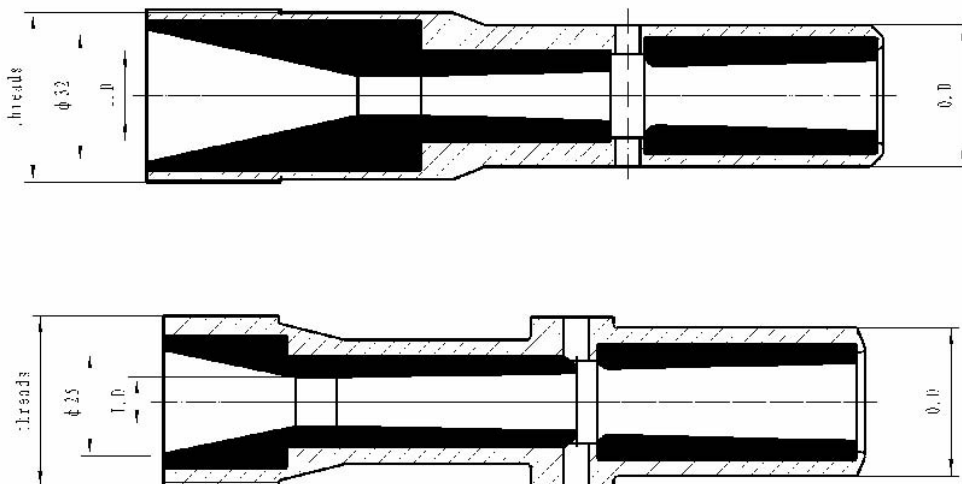

ADD: No.38 XueYuan Nanlu, Haidian District, Beijing, 100082, P.R.China

Tel: (86-10) 62224902; Fax: (86-10)-62224902

Email: like@atmcn.com

<http://www.atmbj.com>



ATM

	I.D.	O.D.	LENGTH
ATM-DVA/B-45	1/4" (6.4mm)	1-5/8" (37mm)	130mm
ATM-DVA/B-50	5/16" (7.9mm)	1-5/8" (37mm)	140mm
ATM-DVA/B-55	3/8" (9.5mm)	1-5/8" (37mm)	170mm
ATM-DVA/B-60	7/17" (11.1mm)	1-5/8" (37mm)	200mm
ATM-DVA/B-65	1/2" (12.7mm)	1-5/8" (37mm)	225mm

STRAIGHT BORE NOZZLES



straight bore nozzles are made for close range spot blasting. With small blast patterns and little overblast, they are good for cleaning small areas: weldments, grillwork, railings. Short straight bore nozzles yield a narrow pattern with little overblast.

ATM-SBA Series boron carbide straight bore nozzles

MODEL NO.	I.D.	O.D.	LENGTH
ATM-SBA-45	1/4" (6.4mm)	1-1/4"(31.8mm)	130mm
ATM-SBA-50	5/16" (7.9mm)	1-1/4"(31.8mm)	140mm
ATM-SBA-55	3/8" (9.5mm)	1-1/4"(31.8mm)	170mm
ATM-SBA-60	7/17" (11.1mm)	1-1/4"(31.8mm)	200mm
ATM-SBA-65	1/2" (12.7mm)	1-1/4"(31.8mm)	225mm

ADD: No.38 XueYuan Nanlu, Haidian District, Beijing, 100082, P.R.China
Tel: (86-10) 62224902; Fax: (86-10)-62224902
Email:like@atmcn.com
<http://www.atmbj.com>

Boron carbide liner with aluminum jacket and threads or flange

Thread Style: 1-1/4 ,11-1/2 N.P.S.M

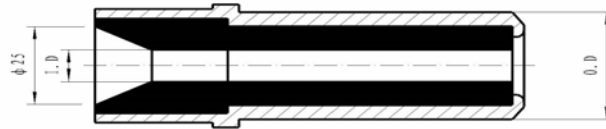

ATM-SBB Series boron carbide straight bore nozzles

Boron carbide liner with aluminum jacket and threads.

Thread Style: 1-1/4 ,11-1/2 N.P.S.M

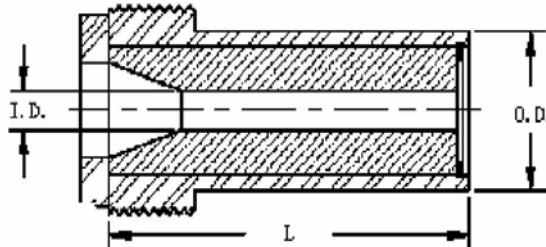

MODEL NO.	I.D.	O.D.	LENGTH
ATM-SBB-40	3/16" (4.8mm)	1-1/4" (31.8mm)	35 to 82mm
ATM-SBB-45	1/4" (6.4mm)	1-1/4" (31.8mm)	35 to 82mm
ATM-SBB-50	5/16" (7.9mm)	1-1/4" (31.8mm)	35 to 82mm
ATM-SBB-55	3/8" (9.5mm)	1-1/4" (31.8mm)	35 to 82mm
ATM-SBB-60	7/17" (11.1mm)	1-1/4" (31.8mm)	35 to 82mm
ATM-SBB-65	1/2" (12.7mm)	1-1/4" (31.8mm)	35 to 82mm

ADD: No.38 XueYuan Nanlu, Haidian District, Beijing, 100082, P.R.China

Tel: (86-10) 62224902; Fax: (86-10)-62224902

Email: like@atmcn.com

<http://www.atmbj.com>

ATM-SBC Series boron carbide straight bore nozzles

Boron carbide inserts.

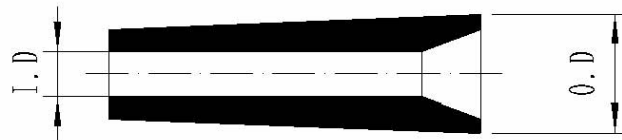
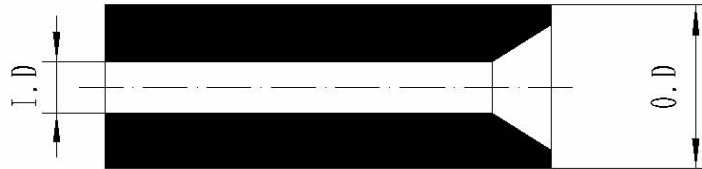

MODEL NO.	I.D.	O.D.	LENGTH
ATM-SBC-40	3/16" (4.8mm)	16 to 22.2mm	35 to 80mm
ATM-SBC-45	1/4" (6.4mm)	16 to 22.2mm	35 to 80mm
ATM-SBC-50	5/16" (7.9mm)	16 to 22.2mm	35 to 80mm
ATM-SBC-55	3/8" (9.5mm)	16 to 22.2mm	35 to 80mm
ATM-SBC-60	7/16" (11.1mm)	16 to 22.2mm	35 to 80mm
ATM-SBC-65	1/2" (12.7mm)	16 to 22.2mm	35 to 80mm

ANGLE NOZZLES

These nozzles are excellent for getting inside tight places like bridge lattice, behind flanges or inside pipe. Many operators waste a abrasive and time waiting for ricochet to get the job done. No nozzle tool chest should be without an angle nozzle. These nozzles are boron carbide lined, with brass or aluminum threads, featuring blast outputs at 45 degree , 90 degree or 135 degree relative to the input openings. Available with single, double, or triple outlets. Special designs available upon request.



ATM-ANG A Series boron carbide angle bore nozzles

Thread Style: 1-1/4 , 1 1/2 N.P.S.M

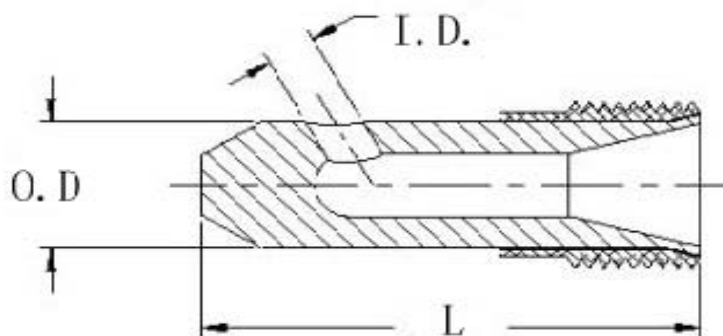

MODEL NO.	I.D.	O.D.	ANGLE	LENGTH
ATM-ANG A-40	3.5mm	16mm	45 degree	2"(50.8mm)
ATM-ANG A-45	4.8mm	16mm	90 degree	2"(50.8mm)
ATM-ANG A-50	6.5mm	16mm	135 degree	2"(50.8mm)

ATM-ANG B Series boron carbide angle bore nozzles threads

Thread Style: ATM-VSA Series 1-1/4 ,11-1/2 N.P.S.M.

ATM-VSB Series 2 ,4-1/2 U.N.C.

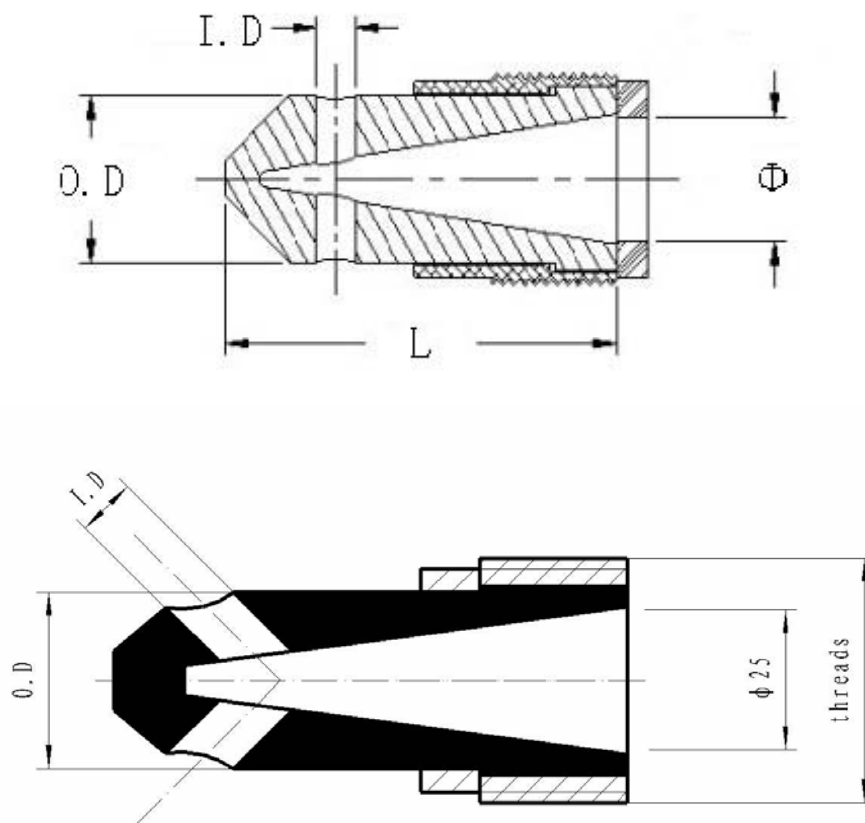

MODEL NO.	I.D.	O.D.	Φ	ANGLE	LENGTH
ATM-ANGB-45	4.8mm	32.5mm	25.4mm	45 degree	79.5mm
ATM-ANGB-50	6.5mm	32.5mm	25.4mm	90 degree	79.5mm
ATM-ANGB-55	7.9mm	32.5mm	25.4mm	135 degree	79.5mm

ADD: No.38 XueYuan Nanlu, Haidian District, Beijing, 100082, P.R.China

Tel: (86-10) 62224902; Fax: (86-10)-62224902

Email:like@atmcn.com

<http://www.atmbj.com>